

DINING BENCH

Stock number: 9199/9234-60

Thank you for purchasing this product. Please read the instructions carefully before use to ensure safe and satisfactory operation of this product.

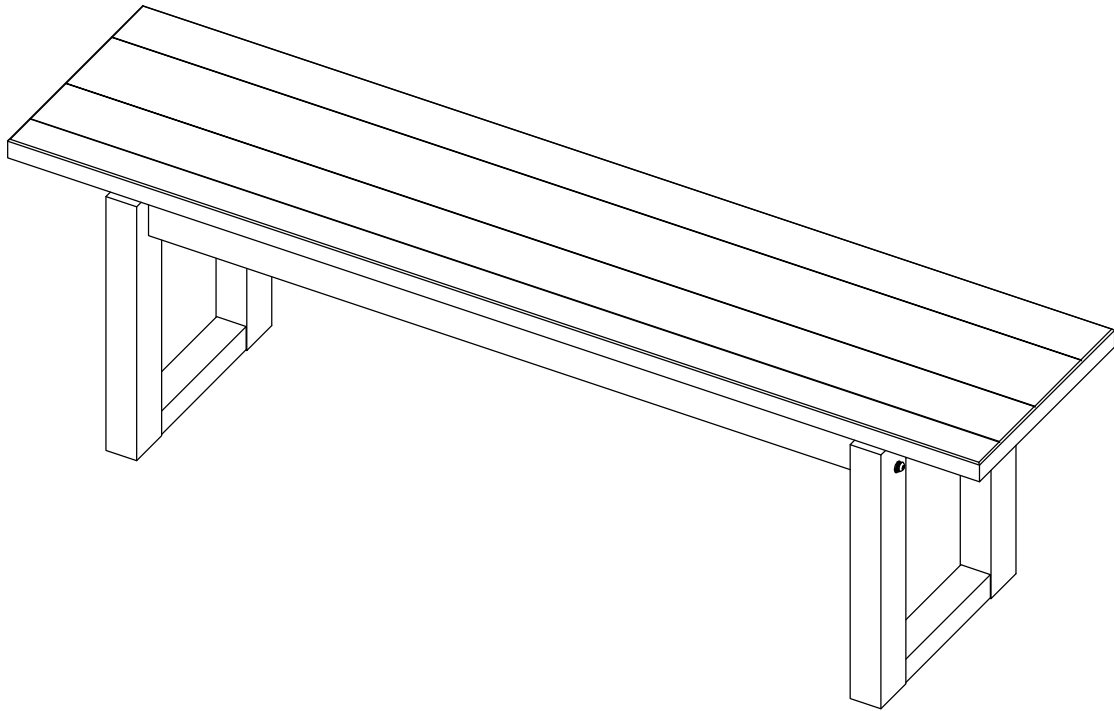

Pre-assembly preparation

Please ensure instructions are read in full before attempting to assemble this product.

Necessary Tools :

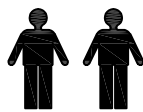

(Included)

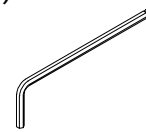

Please check the pack contents before attempting to assemble this product. A full checklist of components is given in this leaflet. If any components are missing, please contact the retailer from whom you bought this product.

This product takes approximately **15 MINUTES** to assemble with **2 PEOPLE**.

All assembly should be performed on a flat, stable, clean and soft surface.

This product is **HEAVY**, it should be assembled as near as possible to the point of use. **TAKE CARE WHEN LIFTING** to avoid personal injury and (or) damage to the product

The fitting pack contains **SMALL ITEMS** which should be **KEPT AWAY FROM YOUNG CHILDREN**.

IMPORTANT: Retain these instructions for future reference.

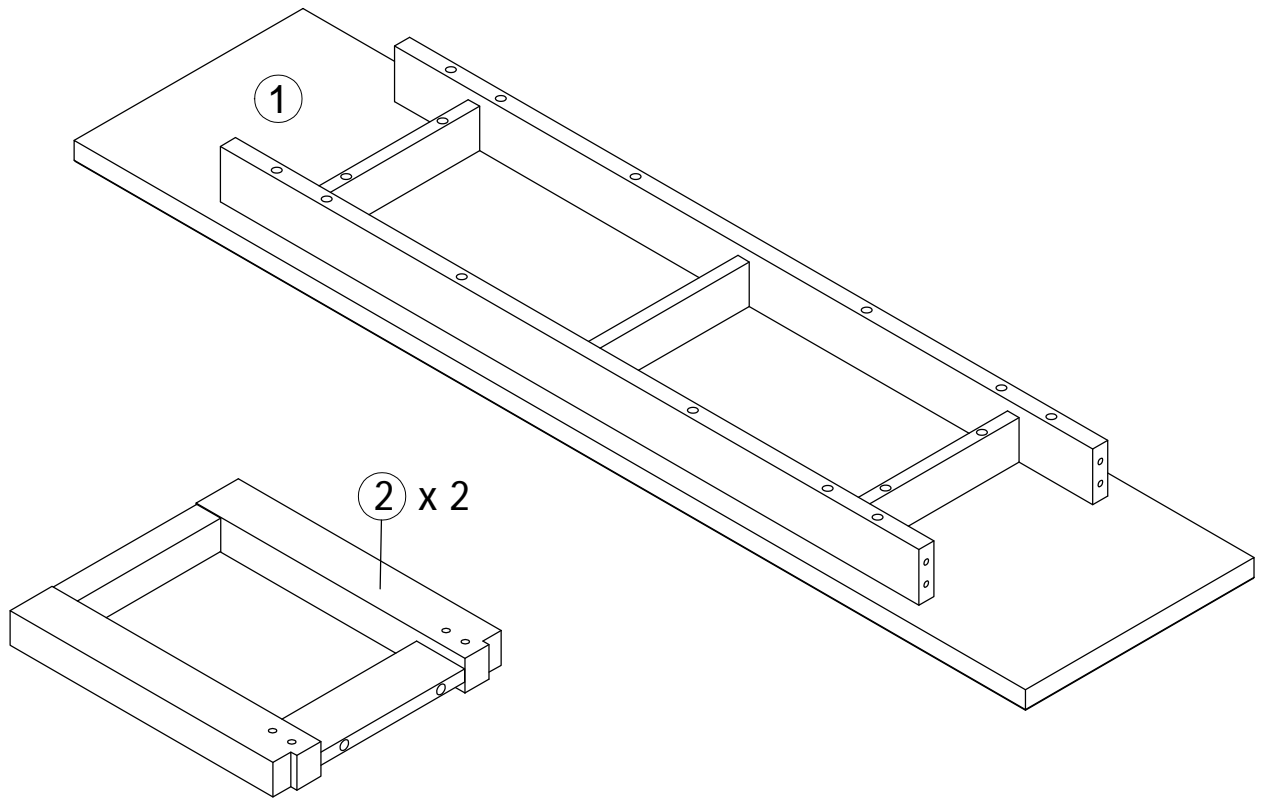

Fittings and parts checklist

Item	Description	Qty.	Item	Description	Qty.
1	Top bench frame	x 1	2	Leg frame	x 2
A	Cross dowel Ø12 x 60mm	x 4	D	Lock washer Ø8.4 x 2mm	x 8
B	Hex head bolt M8 x 140mm	x 8	E	Allen key M5 x 30 x 110mm	x 1
C	Lock washer Ø8.4 x 2mm	x 8			

Step By Step Assembly Instructions

Step 1

1.1 : Lay all parts on a flat, stable, clean and soft surface.

1.2 : Insert 4x cross dowels (A) into the top bench frame (1) by placing each fitting (A) into the holes on top of each side apron as shown.

Fitting

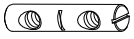

A x 4

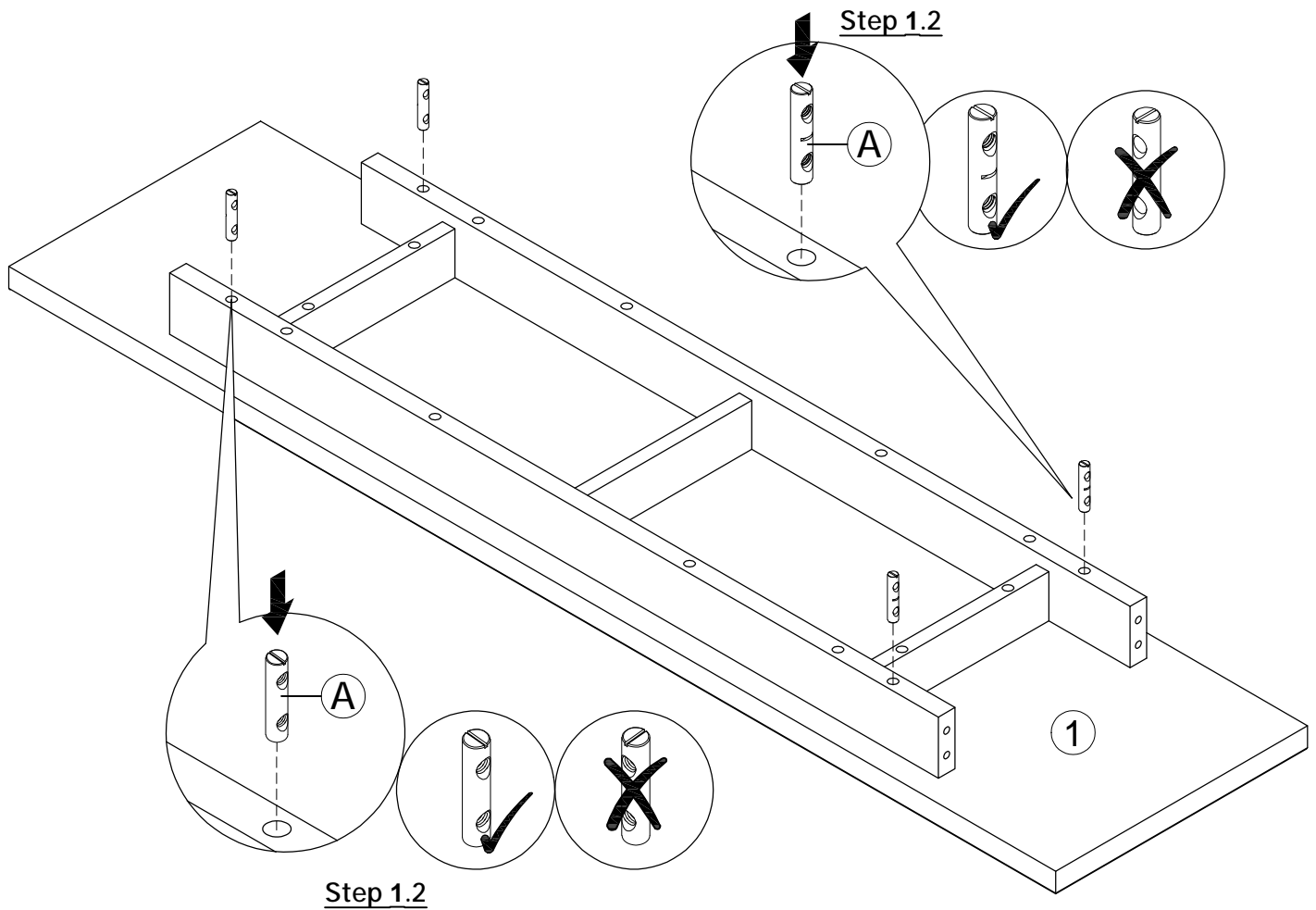

Step By Step Assembly Instructions

- Step 2**
- 2.1 : Attach legs frame (2) onto top bench frame (1). Ensure the pre-drilled holes on legs frame (2) are aligned correctly with the pre-drilled holes on top bench frame (1) before attaching.
 - 2.2 : Secure legs frame (2) to top bench frame (1) by screwing 8x hex head bolts (B), 8x lock washers (C), 8x flat washers (D) into the cross dowels (A) that are located on top bench (1) as shown. Use allen key (E) to turn bolts clockwise to fix.
 - 2.3 : Stand the bench upright.

Fitting

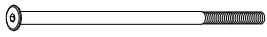

B x 8



C x 8



D x 8

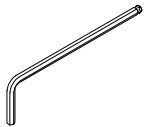

E x 1

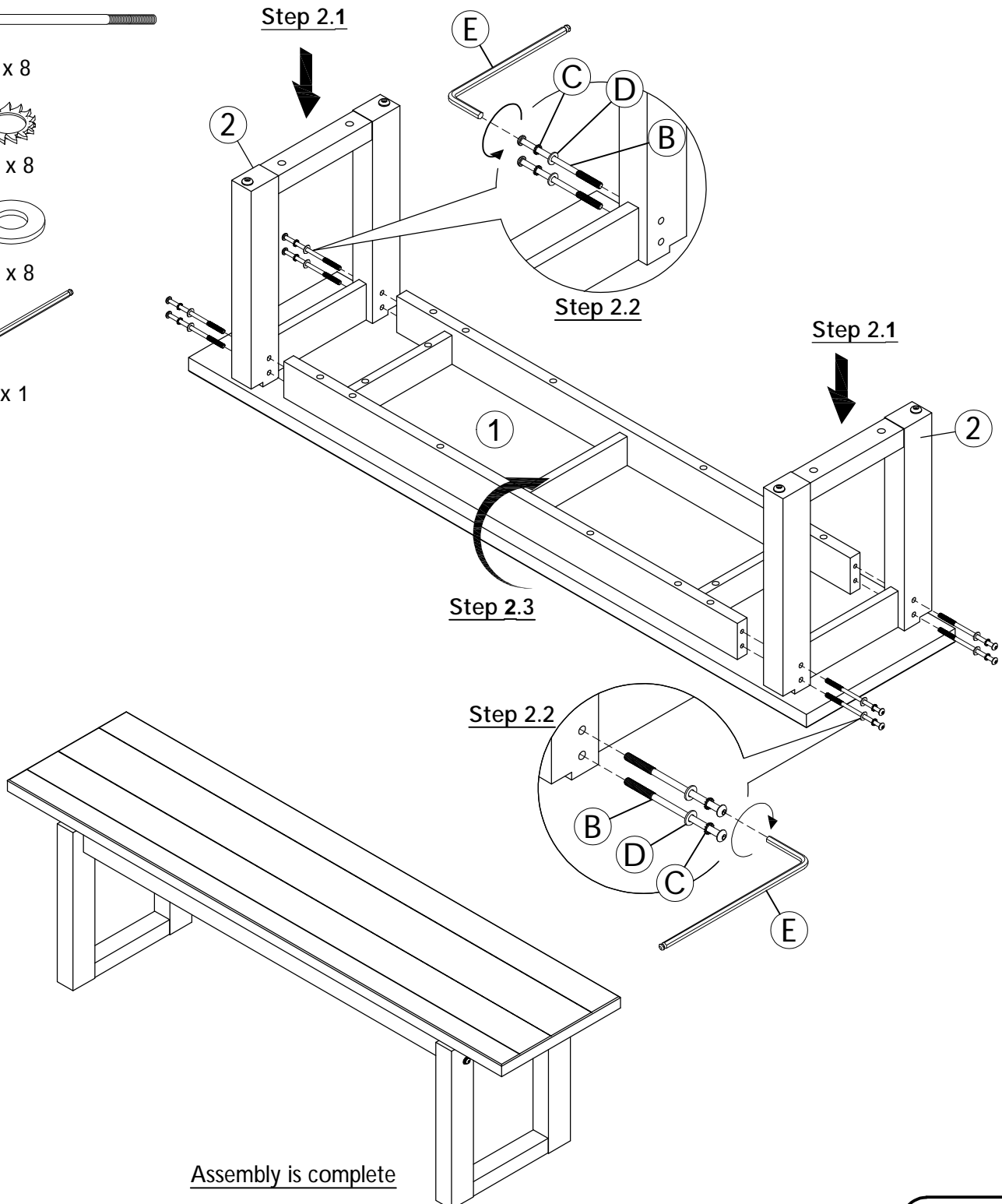

Assembly is complete