

# WIDE SIDEBOARD

Stock number: 3049-15

Thank you for purchasing this product. Please read the instructions carefully before use to ensure safe and satisfactory operation of this product.

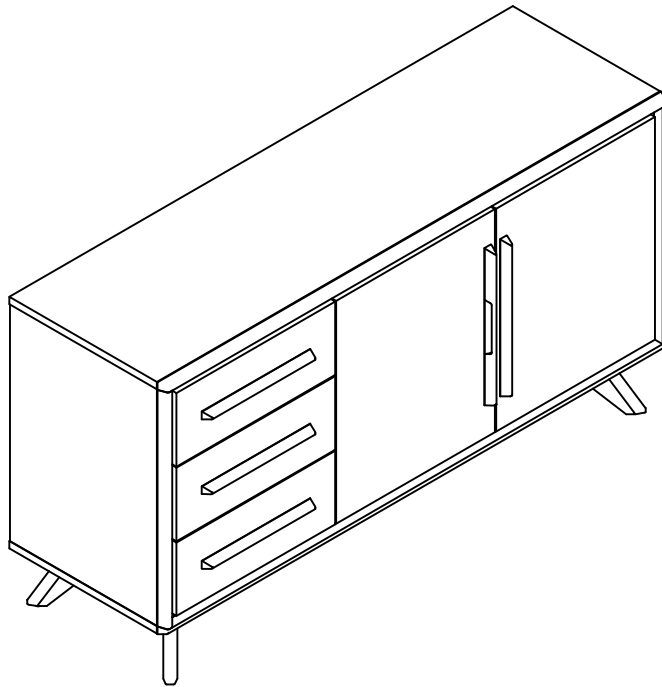

## Pre-assembly preparation

Please ensure instructions are read in full before attempting to assemble this product.

## Necessary Tools

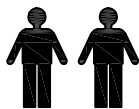

(Included)



Please check the pack contents before attempting to assemble this product. A full checklist of components is given in this leaflet. If any components are missing, please contact the retailer from whom you bought this product.

This product takes approximately **20 MINUTES** to assemble with **2 PEOPLE**.

All assembly should be performed on a flat, stable, clean and soft surface.

This product is **HEAVY**, it should be assembled as near as possible to the point of use. **TAKE CARE WHEN LIFTING** to avoid personal injury and (or) damage to the product.

The fitting pack contains **SMALL ITEMS** which should be **KEPT AWAY FROM YOUNG CHILDREN**.

**IMPORTANT:** Retain these instructions for future reference.

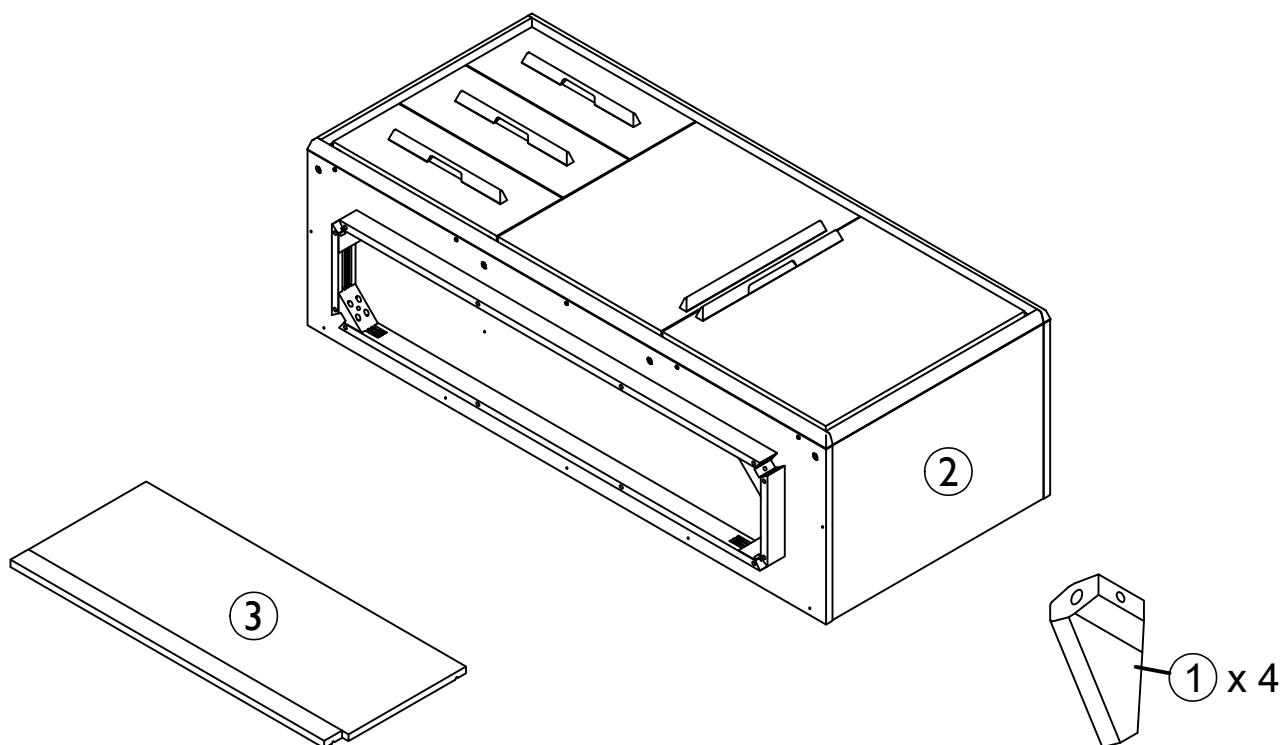

## Fittings and parts checklist

Item	Description	Qty.	Item	Description	Qty.
1	Leg	x 4	3	Adjus Shelf Frame	x 1
2	Top Unit	x 1			
A	Cross dowel M8 x Ø12 x 30mm	x 4	E	Hex nut M8 x 13mm	x 4
B	Threaded bolt M8 x 80mm	x 4	F	Spanner	x 1
C	Flat washer Ø8.4 x Ø17 x 1.6mm	x 4	G	Felt Ø20x6mm	x 4
D	Lock washer Ø8.4 x 2mm	x 4	H	Shelf pin	x 4

# Step by step assembly instructions

## Step 1

- 1.1 : Lay all parts on a flat, stable, clean and soft surface.
- 1.2 : Insert 4x cross dowels (A) into the legs (1) by placing each fitting (A) into the holes on top of each legs (1) as shown. Ensure the horizontal marking on each fitting is facing as shown.
- 1.3 : Screw 4x threaded bolts (B) into fittings (A) that are already concealed in legs (1) as shown. Continue to re-tighten until fittings (B) are securely fastened.

Fitting



A x 4

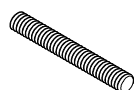

B x 4

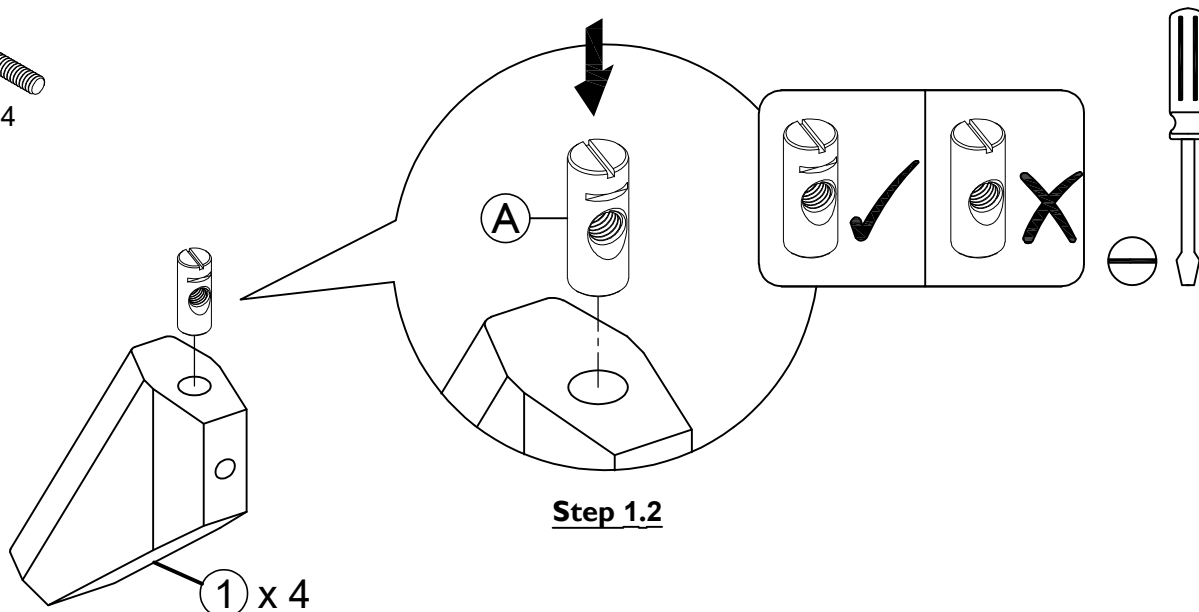

Step 1.2

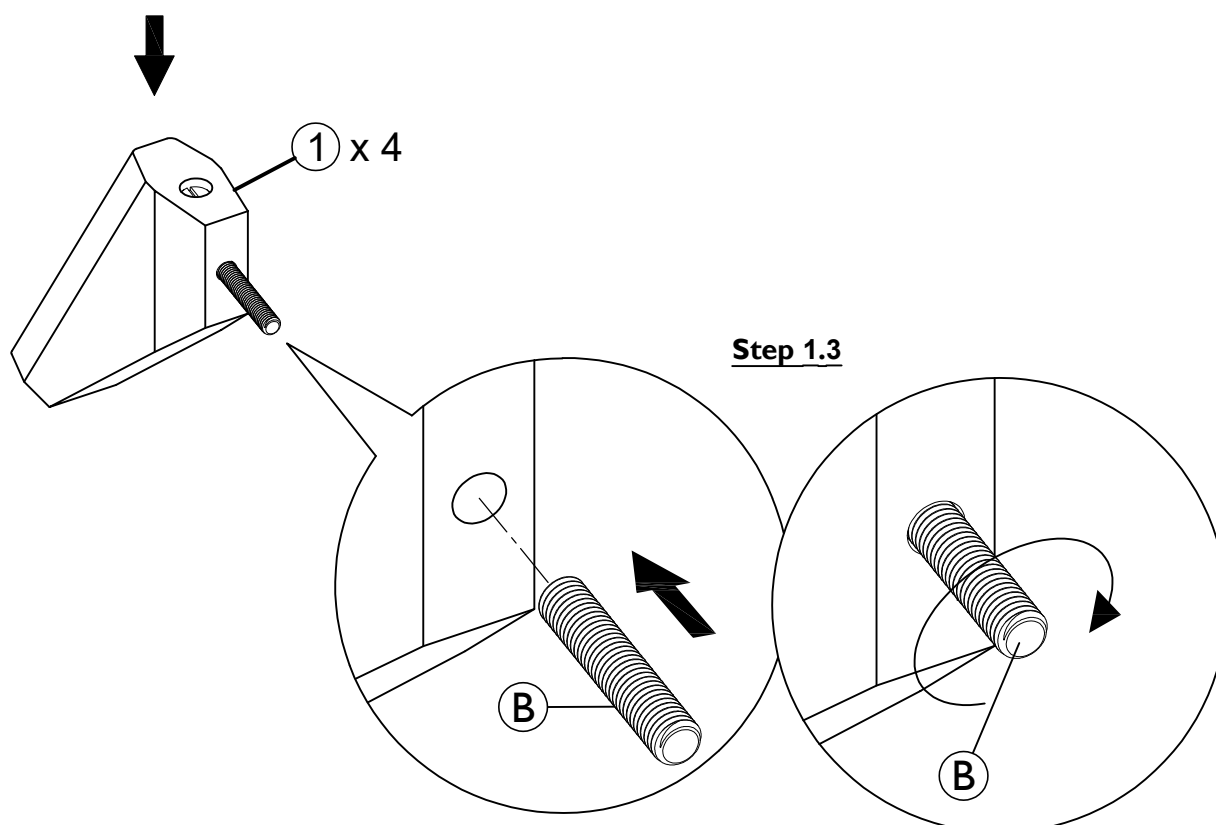

Step 1.3

# Step by step assembly instructions

## Step 2 **Note: Take care when handling unit as drawers can come out completely.**

2.1 : Attach each legs (1) to top unit (2) by inserting threaded bolts (B) into the pre-drilled holes of each corner block as shown.

2.2 : Insert flat washers (C), lock washers (D) and hex nuts (E) onto threaded bolts (B) on legs (1) and in order as shown - (C) followed by (D) followed by (E).

2.3 : Tighten hex nuts (E) using spanner (F) as shown. Continue to re-tighten hex nuts (E) until they are securely fastened.

**Repeat above procedures with the remaining legs (1).**

Fitting

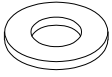

C x 4



D x 4



E x 4



F x 1

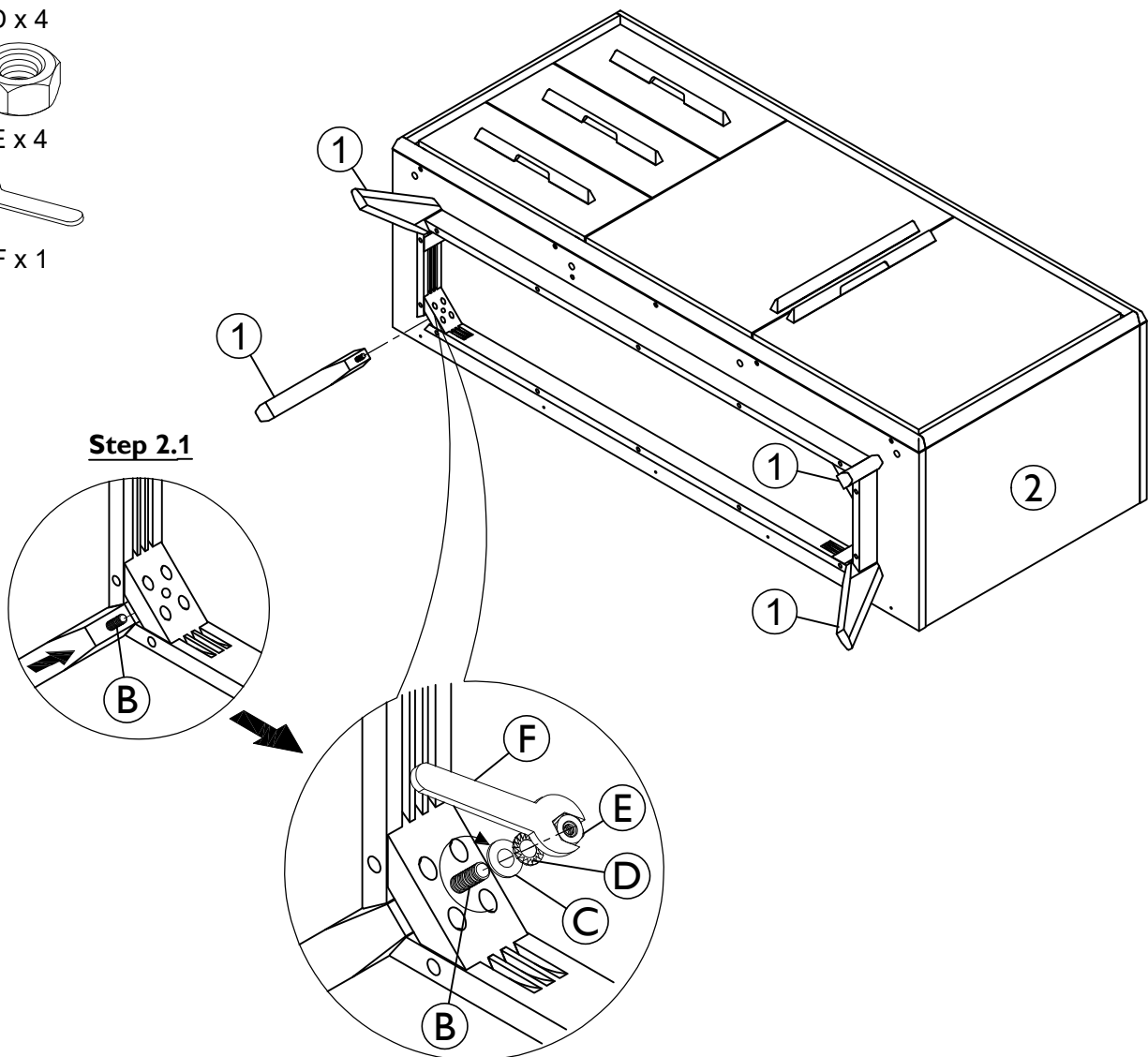

**Step 2.1**

**Step 2.2 & 2.3**

## Step By Step Assembly Instructions

- Step 3** 3.1 : Remove the plastic from 4x felts (G) and stick felts (G) onto under legs (1) as shown.  
3.2 : Stand the unit upright

Fitting



G x 4

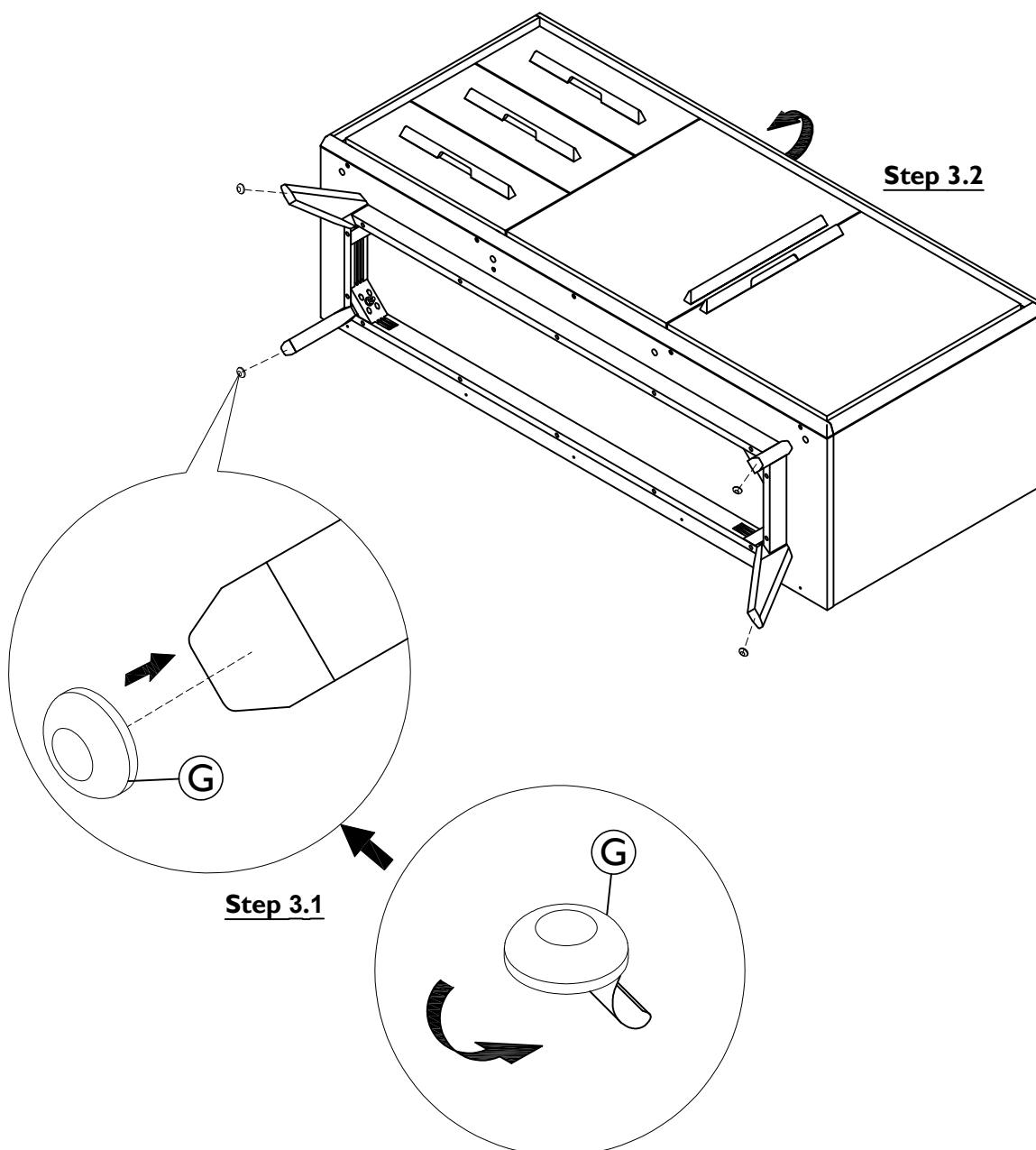

# Step By Step Assembly Instructions

## Step 4

- 4.1 : Screw 2x shelf pins (H) into the inset fittings in the unit as shown.
- 4.2 : Tilt adjustable shelf frame (3) to a suitable angle as shown in the picture so as to slide them in.
- 4.3 : Slide part (3) into the unit. Ensure the notches on adjustable shelf frame (3) are facing down, then place them onto the pins of shelf pins (H) as shown.
- 4.4 : Lift up right side of adjustable shelf frame (3).
- 4.5 : Screw 2x shelf pins (H) into the inset fittings in right side panel of the unit as shown.
- 4.6 : Lower adjustable shelf frame (3) onto the pins of shelf pins (H) as shown.

Fitting



H x 4

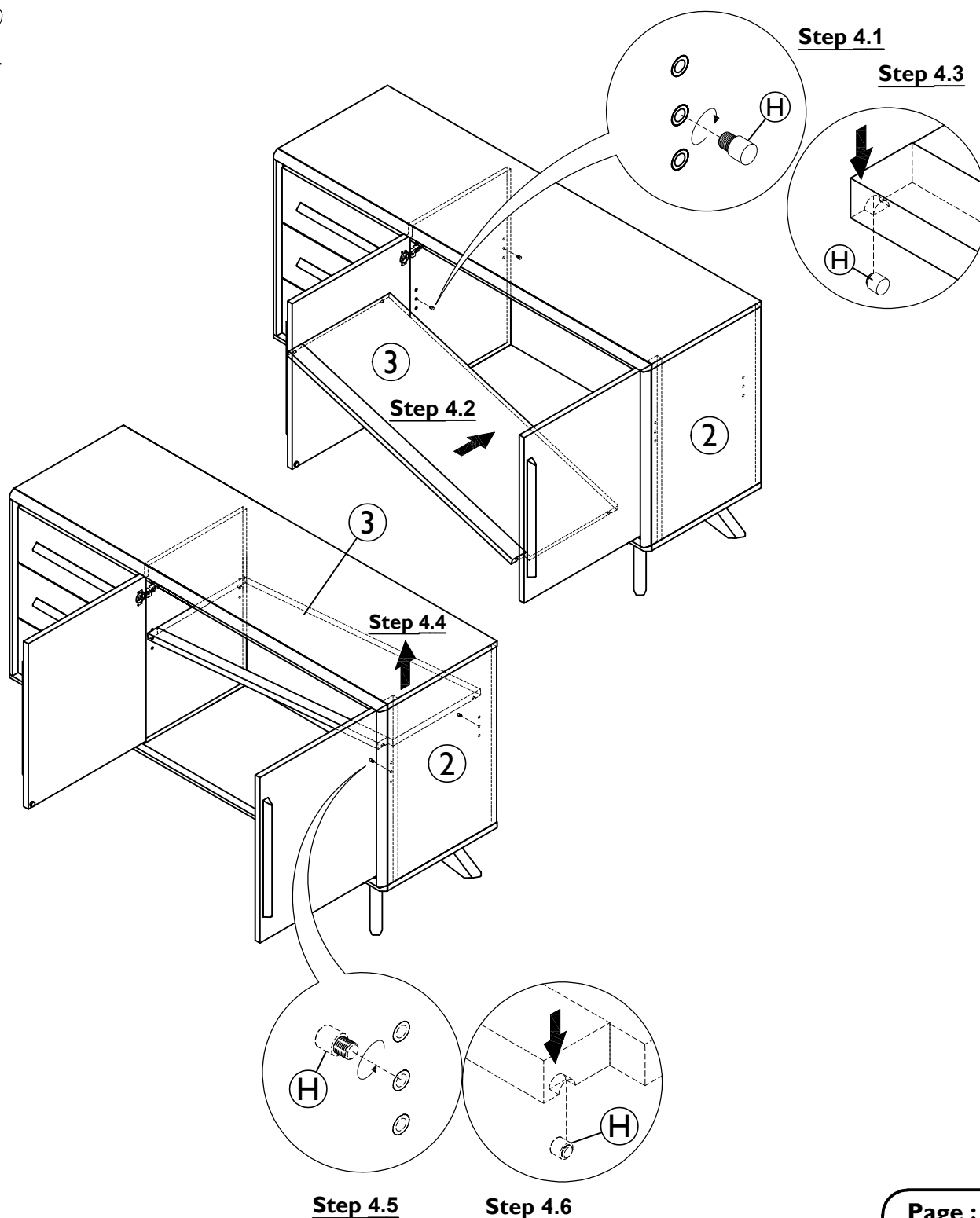

---

# HINGE ADJUSTMENT INSTRUCTIONS

---

## LATERAL ADJUSTMENT

by screw adjustment.

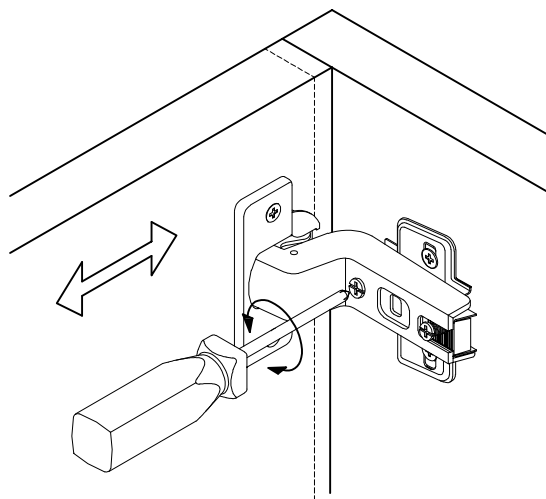

---

## FRONT-TO-BACK

by slackening and retightening the hinge-arm mounting screw.

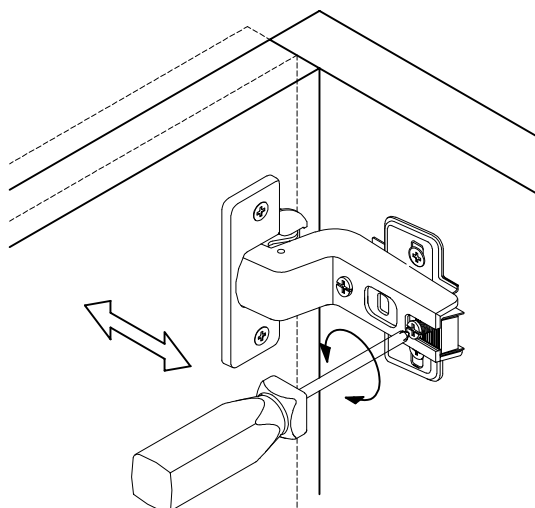

---

## VERTICAL ADJUSTMENT

via slots on mounting plate by slackening and retightening the screws on mounting plate

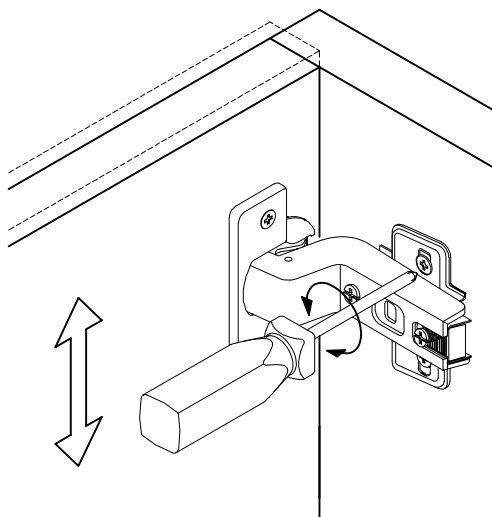

# TANDEM RUNNER ADJUSTMENT INSTRUCTION

## REMOVE

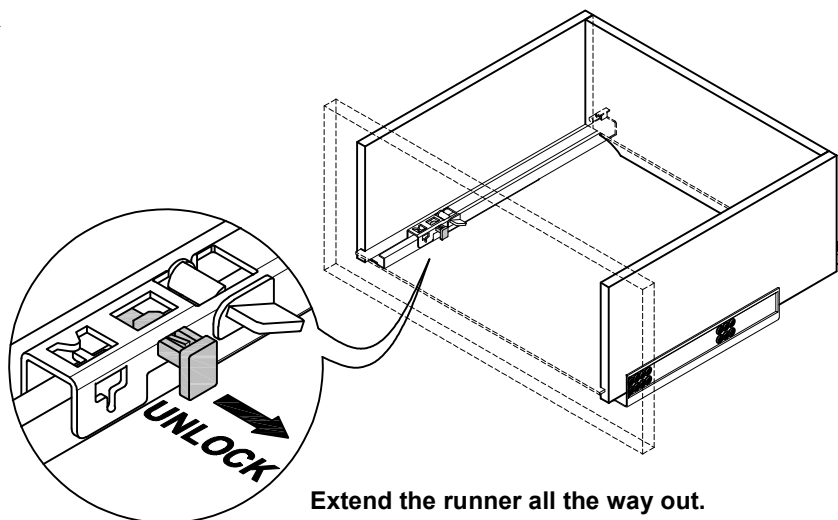

Extend the runner all the way out.  
Unlock by pulling the black plastic peg on the runner out.

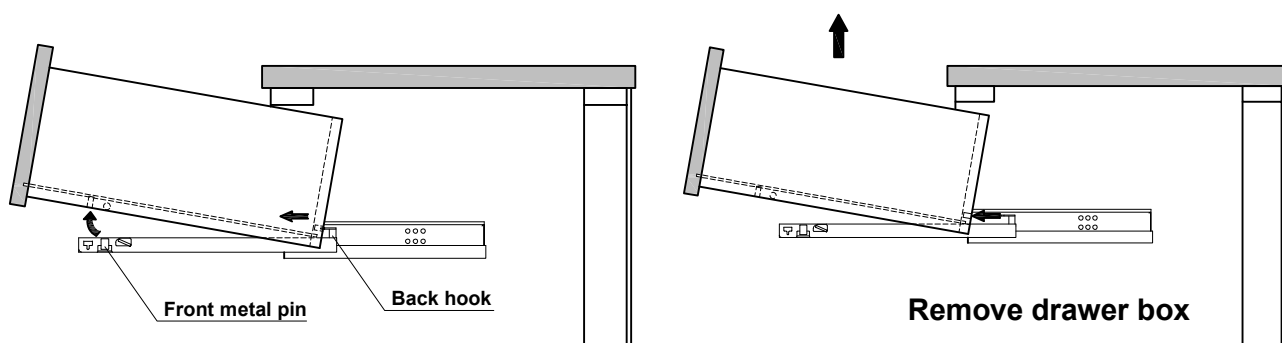

Hold runners with both of your hands.  
Carefully lift the drawer front up from the front metal pin, then slide forward to remove from back hooks.

## VERTICAL ADJUSTMENT ( $\pm 2.5$ mm)

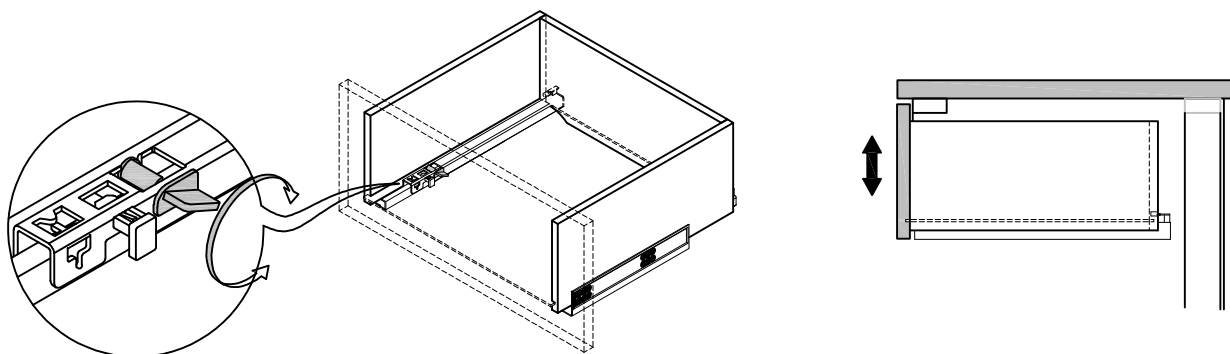



# TANDEM RUNNER ADJUSTMENT INSTRUCTION

## ASSEMBLE

